

Parts Chart for the Wedgle® Direct-Inject™ Tree Injection Unit and Accessories (Parts are not shown to scale)

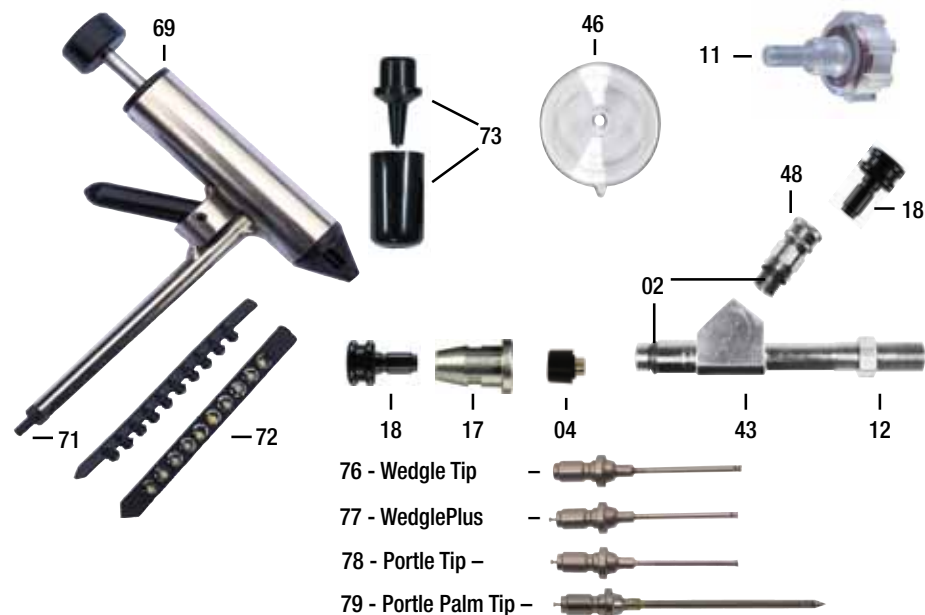

#	Part #	Description	#	Part #	Description
02	PASW202*†	QC Coupler Outer O-Ring	74	PAWP270	Tip Setter
09	PASW209	Screw Lever Pivot	75	PAWP74	Setter Quick Connect Coupling Complete
10	PASWT002	Multi-purpose Tool	76	Wedgle .5	.5" Wedgle Tip
11	PASWT003	Garden Hose Adapter		Wedgle .75	.75" Wedgle Tip
12	PASW12	Lock Nut		Wedgle 1.5	1.5" Wedgle Tip
13	PASW13*†	Piston O-Ring	77	WedglePlus .75	.75" WedglePlus Tip
17	PASW217	Front QC Coupler		WedglePlus 1.5	1.5" WedglePlus Tip
18	PASW218	Dust Plugs (2)	78	Portle .5	.5" Portle Tip
23	PASW23	Piston Spring		Portle .75	.75" Portle Tip
25	PASW25	Dose Adjustment Ring		Portle 1	1" Portle Tip
26	PASW226	Piston Connector Rod		Portle 1.5	1.5" Portle Tip
28	PASW28	Lever Nut	79	Portle 3	3" Portle Palm Tip
41	PASW241*	Handle and Lever Assembly		Portle 8	8" Portle Palm Tip
43	PASW243	Main Body	83	Briefcase	Deluxe Briefcase
44	PASW244	Piston (includes #13)		PASWK203	Annual Maintenance Kit
46	PASW246	Deflector Shield			(not pictured) for units with Replaceable Outlet Check Valve
48	PASW248	Top QC Coupler (includes #2)			(1) Piston O-Ring-#13
52		.5 ml Dose Adjustment Groove			(2) QC Coupler Outer O-Rings-#02
66	PASW66	Rear Hand Grips (2)			(2) QC Coupler Inner O-Rings-#03
69	PAWP75	SpeedChek™ WedgeChek™ Punch			(1) WedgeChek Punch Tip-#71
71	PAWP71	WedgeChek Punch Tip			(1) Replaceable Outlet Check Valve-#04
72	PAWP72‡	SpeedChek™ WedgeChek™ Punch Strips			
73	PAWP73	WedgeChek Adapter, Rubber Sleeve For older style WedgeChek Punch (not shown)			

*Not sold separately. †Part of Annual Maintenance Kit
‡ArborSystems approval required to purchase

NOTE: Not all tip sizes shown

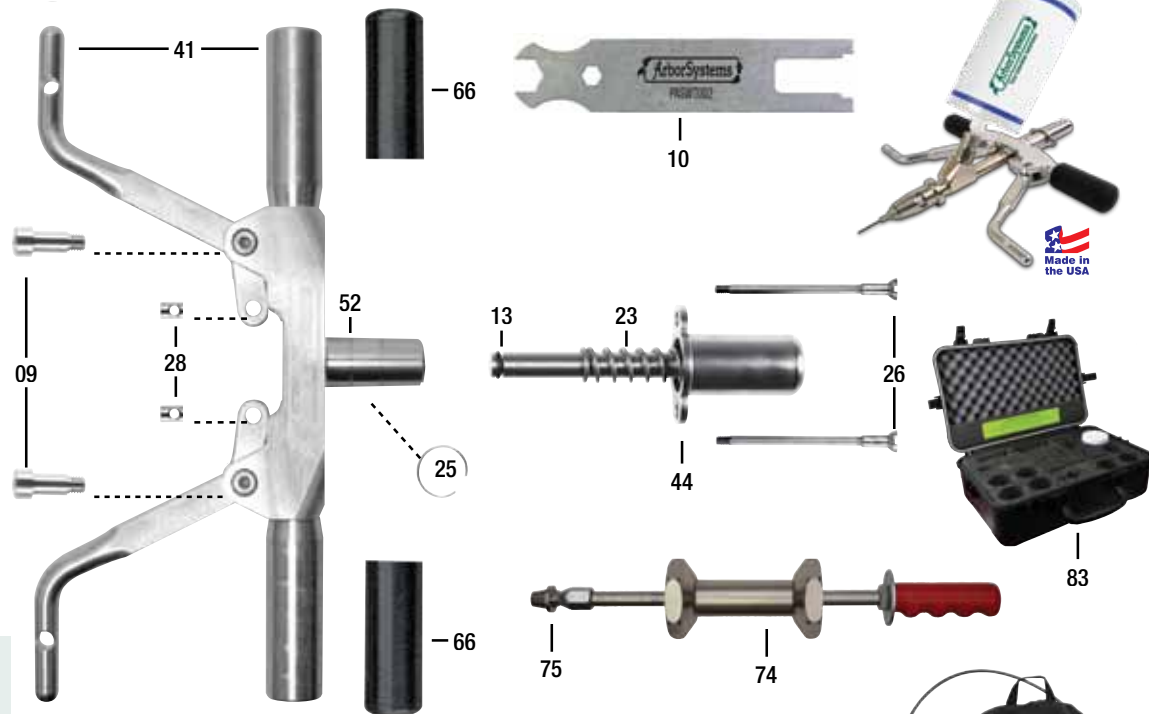

High-Volume Kit (Sold separately)

Make up to 1000 injections without reloading chemical. Simply attach the hose to the Wedgle Direct-Inject unit** and the 1000 ml chemical pack, ** prime, and inject. No other tools, equipment, or power supply are needed.

1. Remove the yellow cap from the hose guide by unscrewing. Remove the adaptor sleeve from inside the hose guide.
2. Slide the High-Volume Hose through the yellow cap and into the hose guide, pulling the hose through the chemical pack cage and out the top of the backpack‡.



3. Attach the hose to a 1000 ml chemical pack** using the same method as you attach a 120 ml chemical pack to the injection unit (see instruction on page 2).

4. Carefully pull the hose and chemical pack into the cage inside the backpack until the chemical pack rest snugly against the hose guide.
5. Secure the chemical pack in the cage with the closure pin.
6. Place the adaptor sleeve over the hose and slide the sleeve into the hose guide.
7. Screw the yellow cap onto the hose guide and hand tighten.
8. Attach the hose to the Top QC Coupler (#48) on the injection unit.
9. Prime and you are ready to begin injecting.

NOTES: When priming or using the High-Volume Kit, the chemical pack should always be at or above the injector.

The High-Volume Hose contains approximately 30 ml of chemical when primed. Priming the hose will take 30 or more pumps of the injector to fill.

‡Picture may differ from actual product. **Sold separately

